

CERTIFIED RECORD OF LAND CORNER MONUMENTATION

X-9

History of original corner establishment:

This corner was originally established by Otis Gould, U.S. Cadastral Surveyor, under special instructions dated Nov. 27, 1935, during his surveys in July through October, 1937. The original notes state that at the corner a marked brass cap on a 1" by 3' long iron post was set 16" in the ground to bedrock and surrounded with a mound of stones to the top from which:

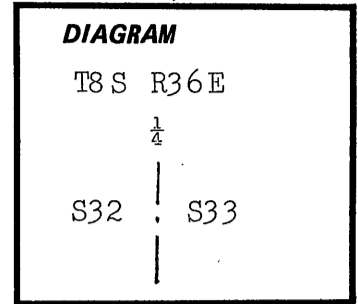

- A 20" spruce bears S71°E-38 lks, marked 1/4 S33 BT.
- A 8" fir bears N5°W-6 lks, marked 1/4 S32 BT.

Description of corner evidence found:

A 2 1/2" brass cap on a 1" iron pipe protruding 18" from a mound of stone from which:

- A 24" spruce bears S76°E-25.1' with healed blaze.
- A 11" white fir bears N6°W-4.0' with scribing visible on an open blaze.

Description of monument and accessories | established to perpetuate the original location of this corner:

Built a mound of stone to the cap on the monument. Attached sign 54-3 and 54-9 and painted face of blaze and a 6" red band around each bearing tree. Set steel fence post South of corner and attached sign 54-9.

Used steel tape and staff compass with 20°E declination, measured to the center of the bearing trees.

This corner was maintained on September 25, 1985

The cap is a standard GLO brass cap marked:

Witness: Bob English.

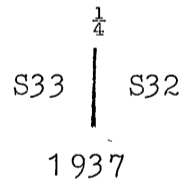

Note: The sections on the cap are stamped in reverse.

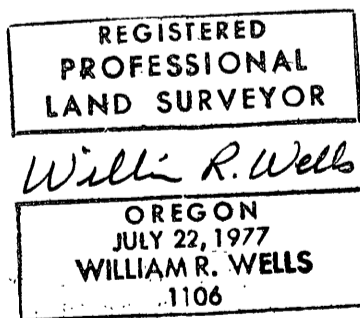

Office of County Surveyor County of Grant
Oregon
 State of I hereby certify that the within instrument was filed in this office
 for record on the 11 day of Feb, 1986
Robert D. Baggett by
 (COUNTY OFFICIAL) (DEPUTY)